

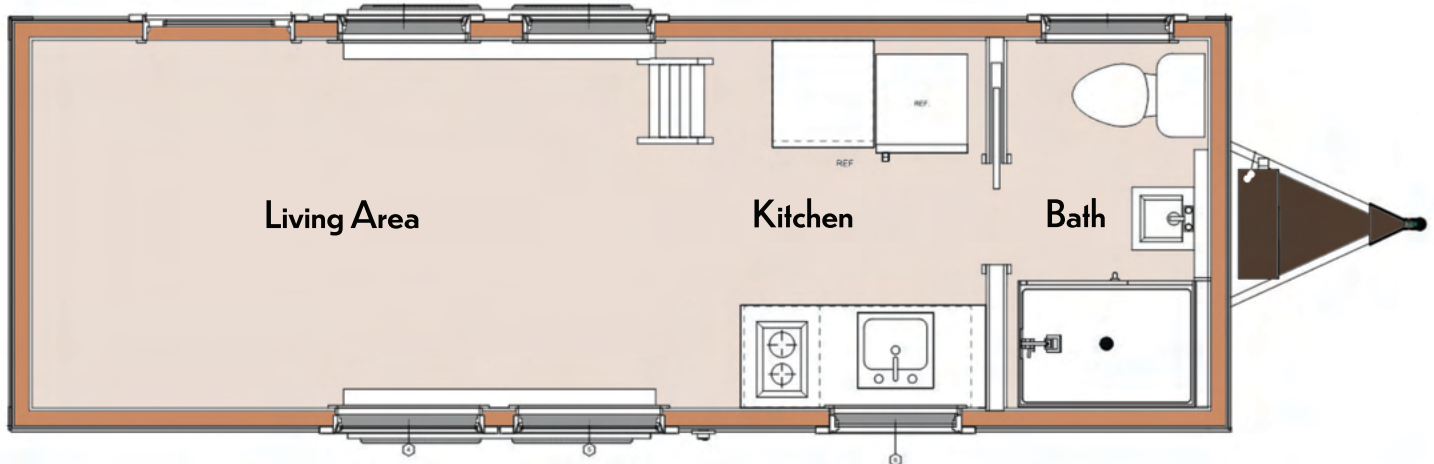

# the Old Crow

Thank you for considering Tiny Homes of Maine to provide you with a quality built tiny home! This 8x24 Old Crow model includes a sleeping loft, kitchen, and bathroom. We use high-quality materials to build well insulated, efficient tiny homes that can withstand any harsh climate. The Old Crow weighs approximately 11,000 pounds and can be towed with a 1 ton truck. Our building facility is located in Houlton, ME and we can deliver throughout the United States. You can place an order for the standard model or customize with additional features

Main Floor Layout



Loft Level Layout

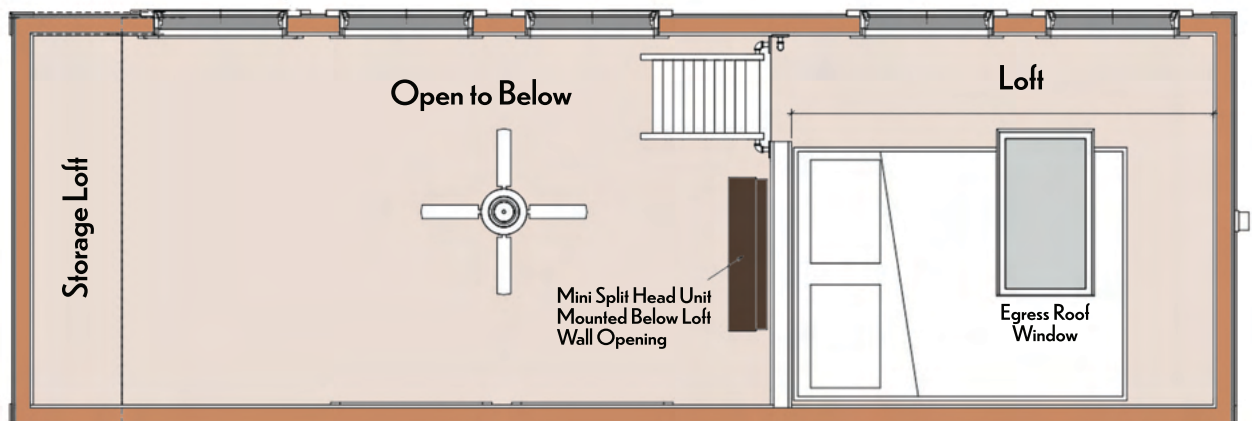

# the Old Crow

## Features Included in Base Price

- Dual axle 141k GVWR trailer base with 4 leveling crank jacks
- 4 tie-down D-rings and galvanized flashing underneath
- Sleeping loft with removable ladder
- 1 egress window in sleeping loft
- Standing seam metal roof
- 400 Series Andersen Awning and Casement Windows (black exterior and pine interior) and insect screens for each
- Full glass outswing door with internal adjustable mini blinds
- Closed cell spray foam in 2x6 roof, Rockwool insulated 2x4 walls and 2" rigid foam with one layer Rockwool insulation in the floor
- Mini split heat pump (electric heating, cooling, and dehumidifying) and condenser mounted on the tongue end
- Stainless steel under mount sink with pull-down spray faucet
- American Walnut butcher block counter tops
- Self-close white kitchen cabinets
- Two burner electric cooktop
- Vented range hood
- Mini Refrigerator
- Under counter washer/dryer combo hook up in the kitchen (appliance not included)
- Bathroom pocket door
- 32x32" shower
- Panasonic bathroom exhaust fan
- Bathroom Vanity with sink
- Flushing toilet
- Recessed LED lighting on dimmer switches and a modern ceiling fan with a light
- All pine interior tongue and groove walls treated with pickled white stain
- Pine bead board ceiling stained in Provincial
- LifeProof vinyl plank waterproof flooring throughout
- Exterior pine trim and clapboard treated with natural color stain or paint
- 100amp electric service and water hook up

