

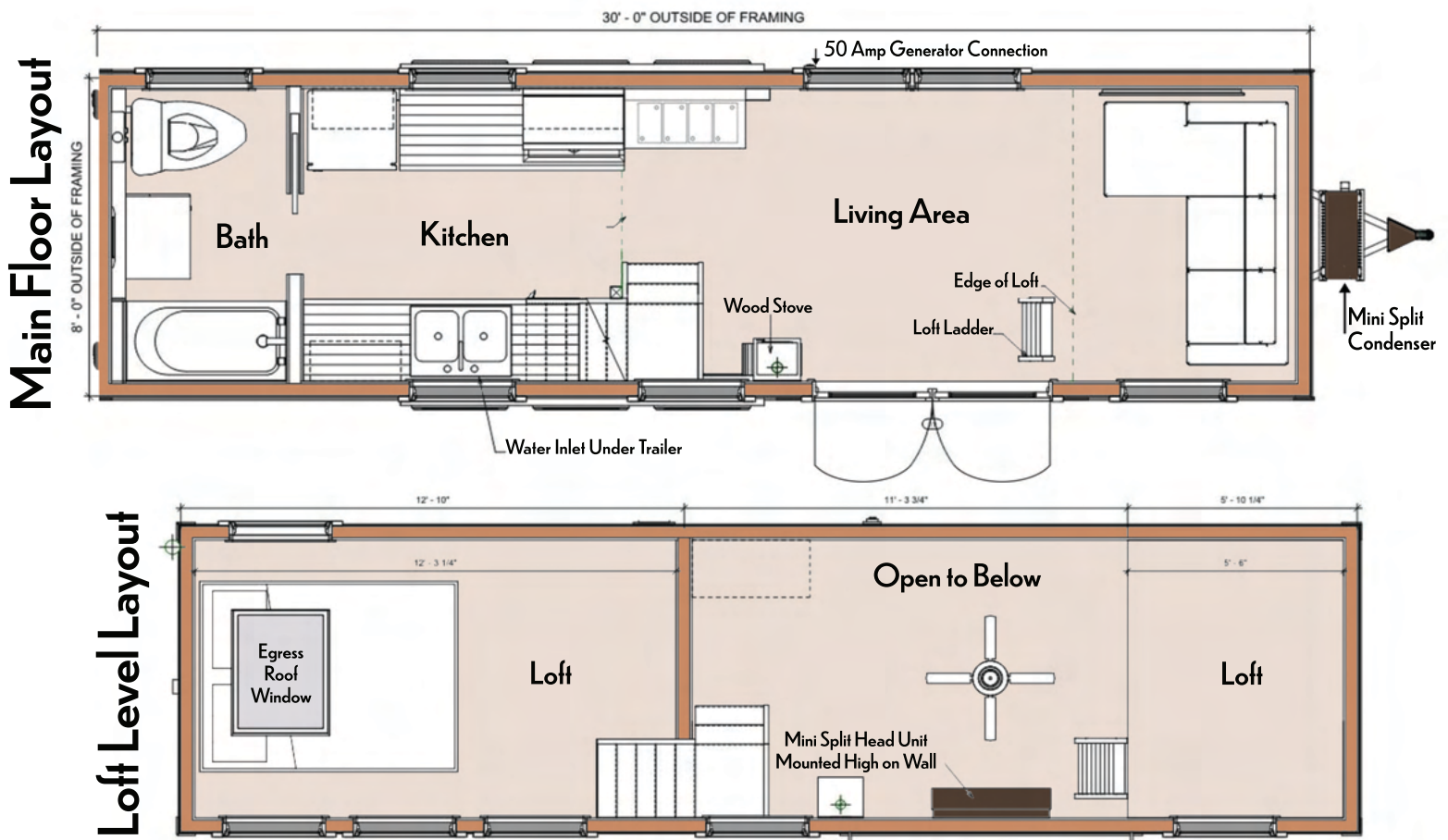

# the Boothbay

Thank you for considering Tiny Homes of Maine to provide you with a quality built tiny home! This 8x30 Boothbay model a combination of several features that include double entrance door and a large kitchen. We use high-quality materials to build well insulated, efficient tiny homes that can withstand any harsh climate. The Boothbay weighs approximately 14,000 pounds and can be towed with a 1 ton truck. Our building facility is located in Houlton, ME and we can deliver throughout the United States. You can place an order for the standard model or customize with additional features.



# theBoothbay

## Features Included in Base Price

Finely crafted home with a large kitchen, sleeping loft and one storage loft.

- Triple axel 21k GVWR trailer base with 4 leveling crank jacks
- 4 tie-down D-rings and galvanized flashing underneath
- Custom ladder to the loft
- Standing seam metal roof
- 400 Series Andersen Awning and Casement Windows (black exterior and pine interior) and insect screens for each
- 1 egress roof window
- full glass double outswing door w/internal adjustable mini blinds
- Closed cell spray foam in 2x6 roof
- Rockwool insulated 2x4 walls and 2" rigid foam with one layer Rockwool insulation in the floor
- Mini split heat pump (electric heating, cooling, and dehumidifying) and condenser mounted on the tongue end
- Stainless steel under mount sink with pull-down spray faucet
- Maple butcher block counter tops
- Hard wood self-close white kitchen cabinets
- 2 burner electric cooktop
- Vented range hood
- 10.1 cu. Ft. refrigerator
- Under counter washer/dryer combo install in the kitchen (appliance not included)
- Bathroom pocket door, 36"x42"
- sterling shower and base
- Panasonic bathroom exhaust fan
- vanity sink with cabinet
- Flushing toilet
- Recessed LED lighting on dimmer switches
- Modern ceiling fan with a light
- All pine interior tongue and groove walls treated with pickled white stain
- Pine bead board ceiling is treated with clear polyurethane
- LifeProof vinyl plank waterproof flooring throughout
- Exterior pine trim painted black and
- Clapboard siding treated with natural color stain
- 100amp electric service and water hook up

